

PLAN OF BASEMENT + GROUND + FOUR STORIED RESIDENTIAL BUILDING AT PREMISES NO:- 82A, NIMTOLLA GHAT STREET, KOLKATA-700 006, IN WARD NO:-020,BOROUGH-II,P.S.-JORABAGAN, WITHIN THE KOLKATA MUNICIPAL CORPORATION, AS PER BUILDING PERMIT NO:-2014020010, DATED-11.07.2014, COMPLYING K.M.C. BUILDING RULE-2009, UNDER SECTION 393 OF K.M.C. ACT-1980. SUBSEQUENTLY RE-VALIDATE FROM 08.12.2020 TO 07.12.2025 & SUBSEQUENTLY REVISED THE PLAN VIDE SL. NO:-005/E.E./Bldg./Br-II/19-20, DATED-26.06.2019. COMPLYING RULE-26(2)(a) & (2)(b) OF K.M.C. BUILDING RULE-2009 APPROVED BY Dy.C.E. (N) Bldg. DATED-28.03.2019.

SCALE-1:100

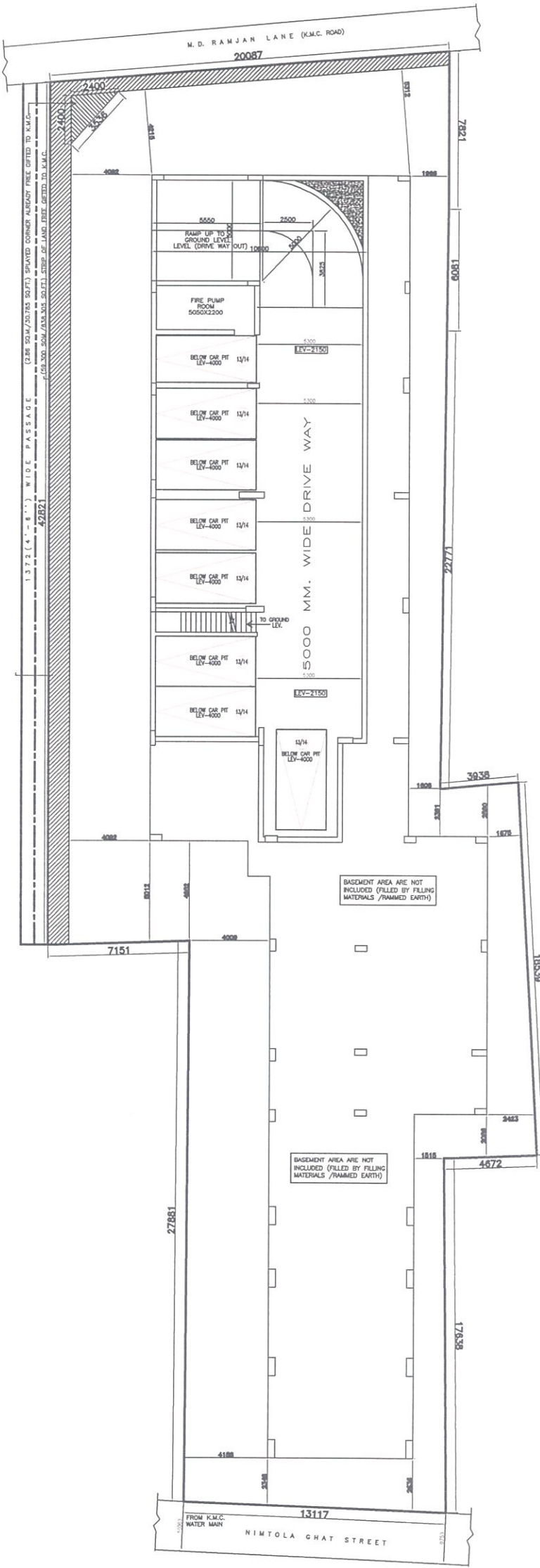

PROPOSED BASEMENT FLOOR PLAN
SCALE-1:100

AREA STATEMENT	
1. AREA OF LAND (AS PER DOCUMENTS)	= 1404.682 SQ.M. (21K-00CH-005FT.)
2. PERMISSIBLE F.A.R.	= 2.250
3. PERMISSIBLE TOTAL BUILTUP AREA	= 3160.534 SQ.M.
4. PERMISSIBLE BUILDING HEIGHT	= 40.00 MT.
5. PERMISSIBLE GROUND COVERAGE	= 702.341 SQ.M. (50%)
6. BASEMENT AREA	= 453.713 SQ.M.
7. GROUND FLOOR BUILT UP AREA	= 571.134 SQ.M.
8. TYPICAL(1ST,2ND,3RD& 4TH) FLOOR BUILTUP AREA	= 658.638 SQ.M.
9. TOTAL BUILTUP AREA	= 453.713+571.134+4X658.638=3659.369 SQ.M.
10. CAR PARKING REQUIRED	= 15 NOS.
11. CAR PARKING PROVIDED	= 25 NOS. (70+325) =395.00 SQ.M.
12. PROPOSED BUILDING HEIGHT	= 15.500 MT.
13. GROUND COVERAGE	= 701.978 SQ.M. (49.97%)
14. F.A.R.	= 2.206
15. PROPOSED BASEMENT AREA	= 324.429 SQ.M.
16. PROPOSED GROUND FLOOR AREA	= 642.510 SQ.M.
17. PROPOSED TYPICAL (1ST,2ND,3RD) FLOOR AREA	= 685.210 SQ.M.
17. PROPOSED FOURTH FLOOR AREA	= 615.747 SQ.M.
19. PROPOSED TOTAL FLOOR AREA	= 324.429+642.510+(685.210X3)+615.747=3666.316 SQ.M.
20. PROPOSED CAR PARKING REQUIRED	= 21 NOS.
21. PROPOSED CAR PARKING PROVIDED	= 21 SQ.M.
22. PROPOSED GROUND COVERAGE	= 701.585 SQ.M.
23. PROPOSED F.A.R.	= 2.249

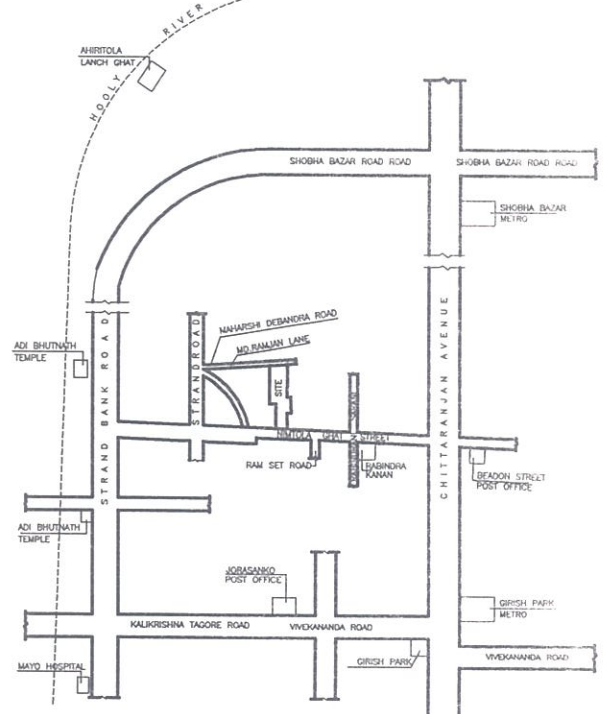

LOCATION PLAN
SCALE-1:600

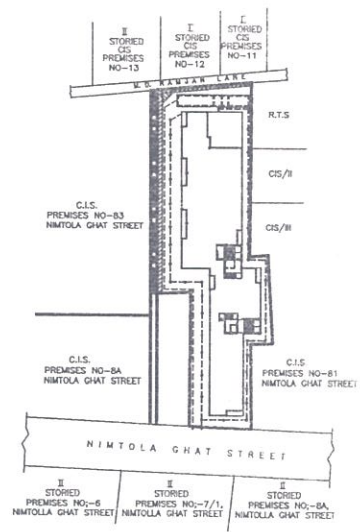

SITE PLAN
SCALE-1:600

Constituted Attorney of
Ashok Jhunjhunwala
Manju Jhunjhunwala
Aditya Jhunjhunwala
Amit Jhunjhunwala
 SIGNATURE OF OWNER

Kamalesh Seal
KAMALESH SEAL, B. Tech (Civil)
 L.B.S. No.:- 1020 (Class-I)
 The Kolkata Municipal Corporation